



CV-A50/A60

Compact Industrial Monochrome CCD Camera



- *New compact size 1/2" and 1/3" monochrome CCD cameras*
- *CCIR: 752 (h) x 582 (v) pixels. EIA: 768 (h) x 494 (v) pixels*
- *Improved sensitivity, dynamic range and smear performance*
- *High S/N ratio up to 60 dB*
- *Extended range of functions and options compared with CV-M50*
- *Shutter speeds from Off to 1/10,000 sec.*
- *Programmable exposure*
- *Interlaced or non-interlaced scanning. Field or frame accumulation*
- *Internal, external HD/VD or random trigger synchronization*
- *Edge pre-select, pulse width control, start/stop trigger modes*
- *Long time exposure with external VD pulse interval*
- *Frame-delay read out in connection with pulse width controlled shutter*
- *Exposure enable EEN, write enable WEN and pixel clock output*
- *Short ASCII commands for fast mode setup via serial port*
- *Setup by Windows 95/98/NT software via RS 232C*

The leading manufacturer of high performance camera solutions

Specifications for CV-A50/A60

Specifications	CCIR	EIA
Scanning system	625 lines 25 frames/sec	525 lines 30/frames sec
CCD sensor CV-A50 CCD sensor CV-A60	Monochrome 1/2" IT CCD Monochrome 1/3" IT CCD	
Sensing area	CV-A50 CV-A60	6.4 (h) x 4.8 (v) mm 4.9 (h) x 3.7 (v) mm
Effective pixels	752 (h) x 582 (v)	768 (h) x 494 (v)
Pixels in video output	737 (h) x 575 (v)	758 (h) x 486 (v)
Cell size	CV-A50 CV-A60	8.6 (h) x 8.3 (v) μ m 6.5 (h) x 6.25 (v) μ m
Resolution horizontal	570 TV lines	
Sensitivity on sensor	CV-A50 CV-A60	0.03 Lux, Max gain, 50% video 0.05 Lux, Max gain, 50% video
S/N ratio	CV-A50 CV-A60	59 dB 58 dB
Video output	Composite VS signal, 1.0 Vpp, 75 Ω	
Gamma	0.45 or 1.0	
Gain	Manual - Automatic	
Gain range	0 to +15 dB	
Accumulation	Field-Frame	
Synchronization	Int. X-tal. Ext HD/VD or random trigger	
Scanning	2:1 interlaced, non-interlaced	
HD sync. input/output	4 V, 75 Ω	
Trigger input	4 V, 75 Ω	
WEN output (write enable)	4 V, 75 Ω	
EEN out. (exposure enable)	4 V, 75 Ω	
Pixel clock output	4 V, 75 Ω	
Shutter	(off), 1/100, 1/250, 1/500, 1/1,000, 1/2000, 1/4000, 1/10,000 sec.	
Pulse width control	1.5 H to 1000 H	
Start/stop	1/50 to 1/10,000 sec.	1/60 to 1/10,000 sec.
Long time exposure	1 field to ∞	
Programmable exposure	2.5 H to 252.5 H	
Frame delay readout	Time from PWC trigger input to ext. VD input	
Functions controlled by RS-232C	Scanning format, Trigger mode, Shutter speed, Trigger/WEN polarity, Accumulation, Shutter mode, Programmable exposure, AGC level, White clip, Setup, Manual gain, AGC/manual gain, Internal/potentiometer gain set, Gamma, Pixel clock, Commands and internal adjustments	
Functions controlled by DIP switches	VD input/output, HD input/output, internal HD and VD 75 Ω termination on/off	
Operating temperature	-5°C to +45°C	
Humidity	20 - 80% non-condensing	
Storage temp./humidity	-25°C to 60°C/20% - 90%	
Power	12V DC \pm 10% 1.5 W	
Lens mount	C-mount	
Dimensions	29 x 44 x 66 mm (HxWxD)	
Weight	150 g	

Trigger/Readout Modes

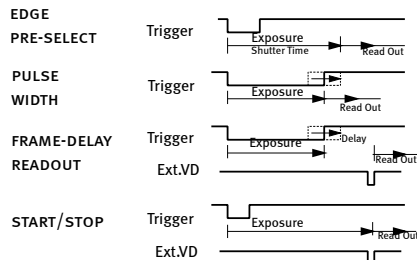

Connection Description

DC-IN/SYNC.

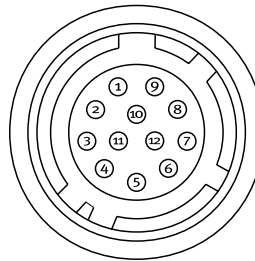

HIROSE HR10A-10R-12P

- Pin
- 1 Ground
 - 2 +12V DC
 - 3 Ground
 - 4 Video output
 - 5 Ground
 - 6 HD input/HD output
 - 7 VD input/VD output
 - 8 Ground
 - 9 Pixel clock output
 - 10 WEN output
 - 11 Trigger input
 - 12 Ground

(Pin configuration compatible with EIAJ standard)

TRIGGER

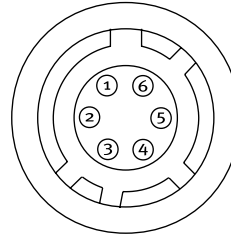

HIROSE HR10A-7R-6P

- Pin
- 1 TXD
 - 2 RXD
 - 3 Ground
 - 4 Ground
 - 5 Trigger input
 - 6 EEN output

Plugs for cable:
12 pin: HIROSE HR10A-10P-12S
6 pin: HIROSE HR10A-7P-6S

Spectral Sensitivity

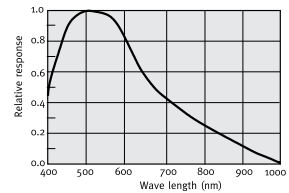

Dimensions

Front view

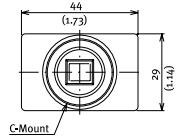

Side view

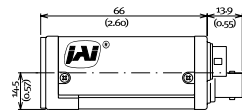

Bottom view

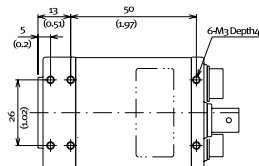

Top view

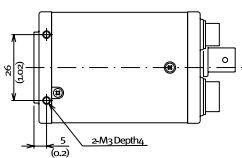

Rear view

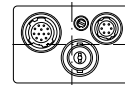

Ordering Information

CV-A50C 1/2" Monochrome Camera. CCIR
CV-A60C 1/3" Monochrome Camera. CCIR
CV-A50E 1/2" Monochrome Camera. EIA
CV-A60E 1/3" Monochrome Camera. EIA
MP40 Tripod Adapter (must be ordered separately)

JAI A-S, Denmark
Phone +45 4457 8888
Fax +45 4491 3252
www.jai.com

JAI Corporation, Japan
Phone +81 45 933 5400
Fax +81 45 931 6142
www.jai.com

JAI UK Ltd., England
Phone +44 1442 879 669
Fax +44 1442 879 281
www.jai.com

JAI Vision OY, Finland
Phone +358 9 8256220
Fax +358 9 870 3345

JAI America Inc., USA
Phone (Toll-Free) +1 800 445-5444
Phone +1 408 383-0300
Fax +1 408 383-0301
www.jai.com

